

To begin your tour please take the elevator to the third floor.

## Third Floor

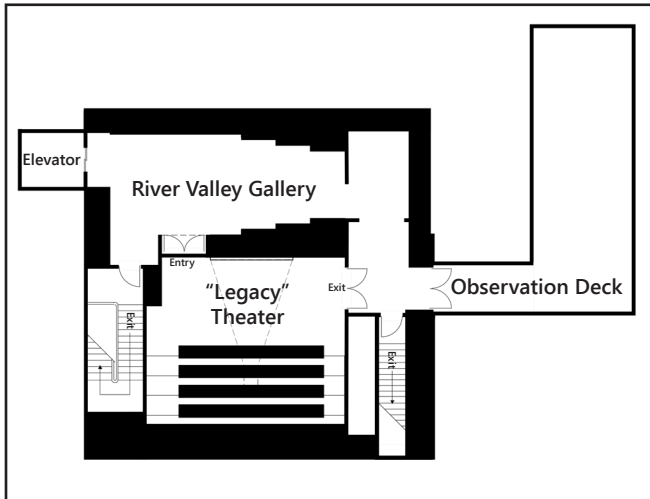

### River Valley Gallery

Discover 12,000 years of human interaction with the natural world of the Illinois River Valley through graphic exhibits. Learn about the Emiquon Preserve located in the bottomland below the museum.

### "Legacy"

Trace people's journey through time in a large-screen video production that captures the panorama of the past. Program begins automatically shortly after you pass through the entry doors. Please do not enter when the doors are closed or when the exit doors are open.

### Observation Deck

View a panorama of sites and sounds of the Illinois River Valley today.

## Second Floor

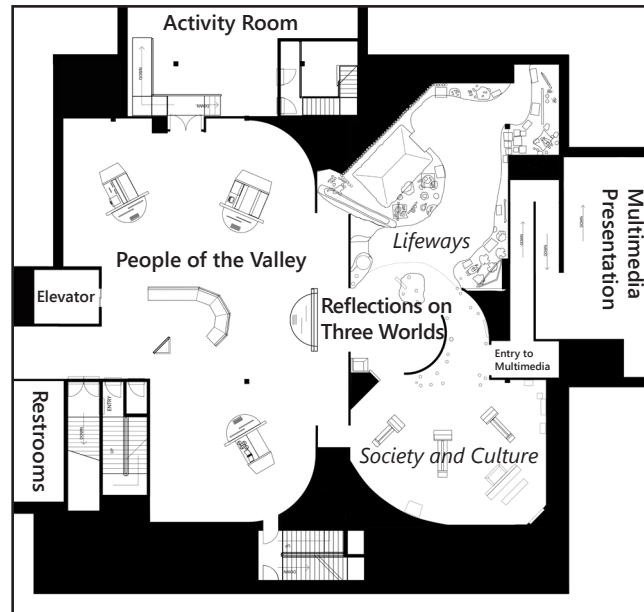

### People of the Valley

Examine the long sequence of peoples and their cultures – from Ice-Age hunters to the tribal groups that left Illinois in the 19th century. This story is told through artifacts, murals, photographs, and hands-on exhibits.

### Reflections on Three Worlds

Explore the world of Mississippian farmers. The 1000-year-old sites of their town, villages, camps, and burial grounds surround the museum today. The exhibits reflect the *Lifeways*, and *Society and Culture* of these people. They lead to a multimedia presentation that takes you through a kaleidoscope of images – the sights, sounds, symbols, music, voices, and mystery of the three worlds of Mississippian belief.

## First Floor

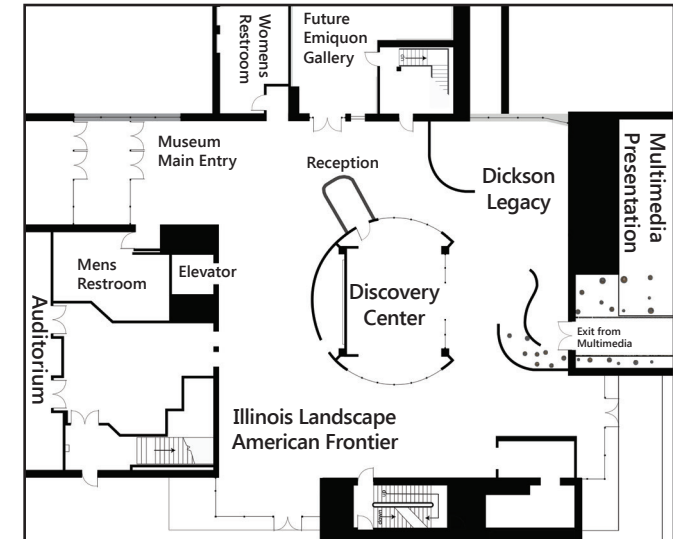

### The Discovery Center

Enter a learning place with hands-on activities for visitors of all ages; discovery drawers, books, videos, and a unique playscape.

### Dickson Legacy Exhibit

Learn how the museum has developed and changed over the course of eight decades.

### Illinois' Natural Landscape & American Frontier Exhibits

(construction in progress)

Consider the rich historic natural resources of the Illinois River Valley and how those resources have been changed over time. Visit a replica log cabin to learn about Euro-American settlement of the Illinois frontier.

**Emiquon Gallery** (Exhibits under development)

# A Visitor's Guide to Dickson Mounds Museum Grounds

The Dickson Mounds Museum grounds also has walking trails. For more information please pickup a trail guide at the Museum during open hours, download one from our website visitor information page, or use the code below.



Dickson Mounds Website



Trails Brochure



Mobile Device Friendly Trails Map



Dickson Mounds Facebook Page

**ILLINOIS STATE MUSEUM**  
**DICKSON MOUNDS**  
*explore. discover. learn. share.*



**Site Grounds Hours:** 8:30 a.m. to Dusk every day.  
**Museum Hours:** 10:00 a.m. to 4:00 p.m. Tue. - Sat., except for New Year's, Thanksgiving, and Christmas Day. Site hours may vary. Please call (309) 547-3721 for information.  
**Admission:** Free, donations are appreciated.

**Illinois State Museum-Dickson Mounds**  
10956 N. Dickson Mounds Rd.  
Lewistown, IL 61542-9733  
(309) 547-3721  
dicksonmounds.com

